

Sierra Vista
 4711 S Highway 92
 1-800-559-9291 Phone
 520-458-9293 Fax



COMMERCIAL POOL CARE DIVISION

Northwest
 6320 N Oracle Rd
 520-797-2299 Phone
 520-797-9293 Fax

Central
 2512 N Campbell Ave
 520-795-8240 Phone
 520-327-1142 Fax

Main Office/Eastside
 7960 E 22nd St
 520-886-1211 Phone
 520-886-6364 Fax

Northeast
 9155 E Tanque Verde Rd
 520-749-9155 Phone
 520-760-0035 Fax

PATIO'S NUMBER	ITEM KEY	BERMUDA GUNITE SKIMMER	MANUFACTURER NUMBER
SP3-5693 SP2-5663	1	Screw, # 8-32x1" S/S (Requires 2)	51-6242
	2	Deck Lid, White Deck Lid, Tan Deck Lid, Black	51-6215 51-6216 51-6306
05-0051	3	Lid Collar, White Lid Collar, Tan Lid Collar, Black	51-6253 51-6258 51-6329
	4	Basket	51-6112
	5	Trimmer Screw, # 8x1/2" S/S	51-6243
	6	Trimmer Plate	51-6228
	7	Weir Gate Assembly Weir Gate Assembly, Black	51-6252 51-6315
SPS-3879	8	Vacuum Plate Assembly	50-6161
	9	Float Valve Assembly	

OPTIONS

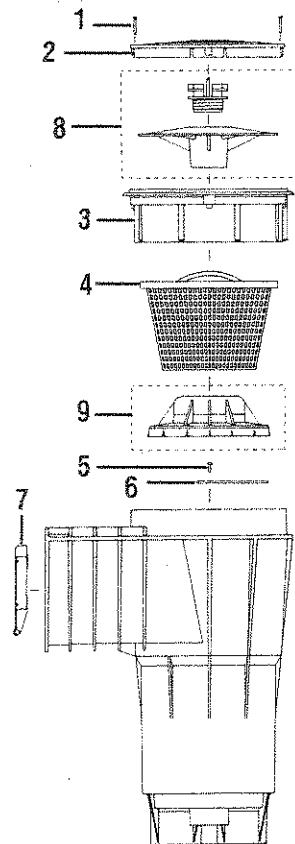

BERMUDA GUNITE SKIMMER